

SCHLAGE®

S-Series Heavy-Duty Residential/Standard Duty Commercial

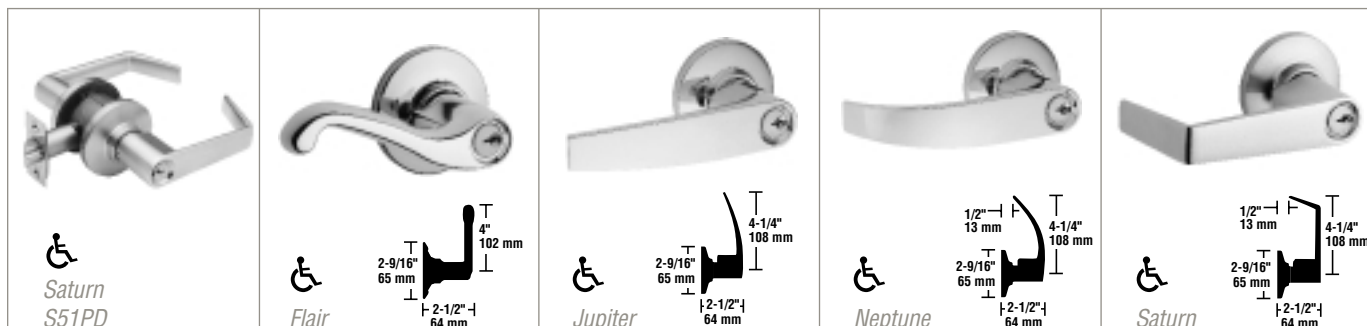

SPECIFICATIONS

Applications Interior light to medium duty commercial doors; office tenant, laboratories, passage and entrance doors. Heavy-duty residential doors: single and multi-family housing.

Certifications ANSI A156.2, 1996, Series 4000 Grade 2. UL/cUL Listed for all functions up to 3-hour doors.

Exposed Trim Levers are pressure cast zinc, plated to match finishes indicated. Roses, latch faceplates and strikes are wrought brass or bronze.

Keying 6-pin tumbler with two nickel silver keys per lock. Stock locks are keyed 5-pin. Other keying options available from the factory include master keying, grand master keying, construction keying and interchangeable core. Also available with Primus® high-security cylinders and Everest™ patent protected keying system.

Door Range 1-3/8" to 2" (35mm to 51mm), except S40D: 1-3/8" to 1-7/8" (35mm to 48mm).

Backset Universal backset latches standard, fit either 2-3/8" (60mm) or 2-3/4" (70mm) backsets. 5" (127mm) backset latches available.

Deadlatches Latches are furnished in brass, bronze or chrome finishes, compatible with lock trim. All S-Series latches have a 1/2" (13mm) throw. Orders for complete locks are provided with a G506-815 sleeve for latches installed in doors with 1" (25mm) edge bore.

Strikes Square corner, 1-1/8" x 2-1/4" x 3/32" (29mm x 57mm x 2mm) T strike with 1-1/8" (29mm) lip, furnished with dust box, #10-001 is standard. Optional lip lengths 1" to 2" (25mm to 51mm). 1/4" (6mm) radius round corner strikes and ANSI 1-1/4" x 4-7/8" (32mm x 124mm) strikes are also available.

STANDARD FEATURES

- Exceeds 400,000 cycle ANSI Grade 2 requirements.
- Exceeds 450 Lbf-in lever torque ANSI Grade 2 requirements.
- Interlocking chassis and latchbolt.
- Snap-on inside rose conceals mounting screws.
- Key removable outside lever for quick and easy cylinder replacement.

ADA-COMPLIANT PRODUCTS

In compliance with the American National Standards Institute (ANSI A117.1) and the Americans with Disabilities Act (ADA), Schlage Lock Company offers a wide selection of locks designed for the needs of the physically challenged.

Designed and manufactured for use on heavy-duty residential and light to medium duty interior commercial doors.

FINISHES

Levers	605	606	609	612	613	625	626
Flair	■	■	■	■	■	■	■
Jupiter	■	■			■	■	■
Neptune	■	■			■	■	■
Saturn	■	■	■	■	■	■	■

Note: S40D privacy lock function is available with split finish inside trim 625 in all designs. No other split finishes are available.

DOOR PREPARATION

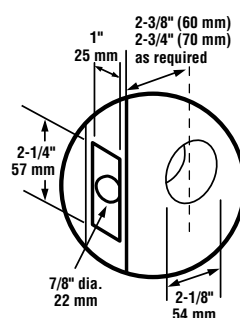

See templates.

S200-Series Interconnected Locks

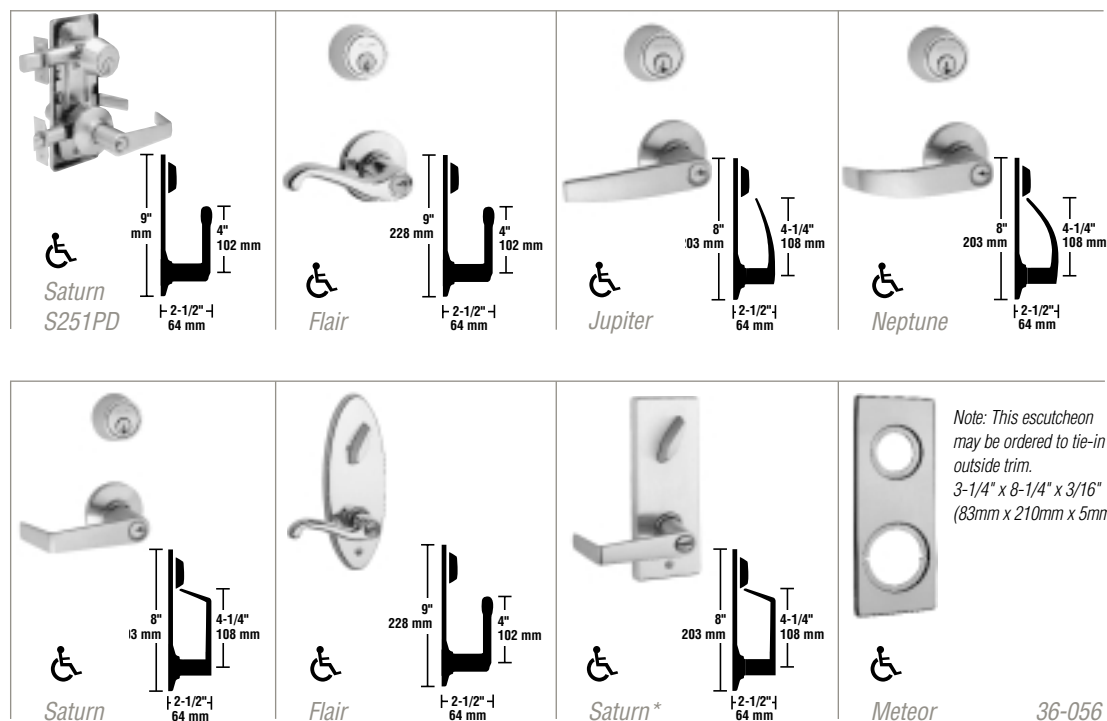

SPECIFICATIONS

Applications Single and multi-family residential, office, hotel/motel and commercial applications. Simultaneous latch and bolt retraction for rapid exit.

Certifications ANSI A156.12, 1992, Grade 2. UL/cUL Listed for all functions for up to 3-hour doors.

Exposed Trim Levers are zinc based, plated to match finishes indicated. Roses and escutcheons, latch faceplates, strikes and Meteor escutcheons (36-056) are wrought brass or bronze.

Keying 6-pin tumbler with two nickel silver keys per lock. Stock locks are keyed 5-pin. Other keying options available from the factory include master keying, grand master keying, construction keying and interchangeable core. Also available with Primus® high-security cylinders and Everest™ patent protected keying system.

Door Range 1-3/8" to 2" (35mm to 51mm).

Backset 2-3/8" (60mm) standard. 2-3/4" (70mm) and 5" (127mm) backsets available.

Latches 1-1/8" (29mm) x 2-1/4" (57mm), 1/2" (13mm) throw. 7/8" (22mm) housing latches are provided with 1" (25mm) sleeves as standard.

Deadbolt 1" (25mm) throw stainless steel deadbolt is standard.

Strikes Furnished with standard B600-Series and S-Series strikes. Optional B600 and S-Series strikes available.

*Inside Saturn design escutcheon also used for Jupiter and Neptune designs.

STANDARD FEATURES

- Exceeds 400,000 cycle ANSI Grade 2 requirements.
- Interconnected latchbolt and deadbolt chassis.
- Independent heavy-duty torsion springs.
- Key removable outside levers for quick cylinder replacement.
- Large inside thumbturn for easy deadbolt operation.

ADA-COMPLIANT PRODUCTS

In compliance with the American National Standards Institute (ANSI A117.1) and the Americans with Disabilities Act (ADA), Schlage Lock Company offers a wide selection of locks designed for the needs of the physically challenged.

FINISHES

Levers	605	606	609	612	613	625	626
Flair	■	■	■	■	■	■	■
Jupiter	■	■			■	■	■
Neptune	■	■			■	■	■
Saturn	■	■	■	■	■	■	■
Meteor (36-056)	■	■	■	■	■	■	■

DOOR PREPARATION

